

LEGEND:

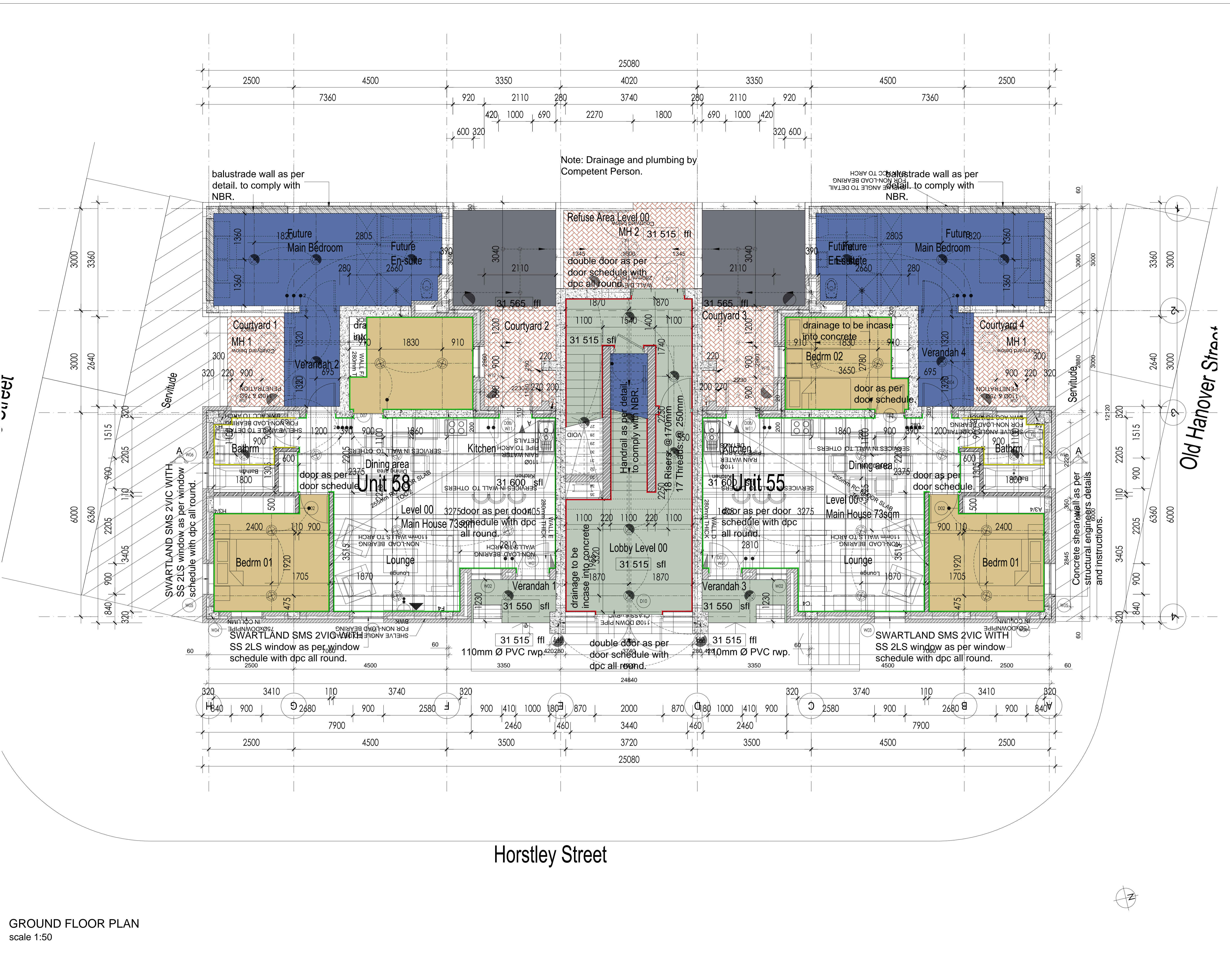

GROUND FLOOR PLAN
scale 1:50

| Rev. | Date | Description of changes | By |
|-----------|------|------------------------|----|
| REVISIONS | | | |

| Rev. | Date | Description of changes | By |
|-----------|------------|----------------------------|----|
| 1 | 2019-05-10 | RE-ISSUED FOR CONSTRUCTION | DS |
| REVISIONS | | | |

Client

Department:
Rural Development and Land Reform
REPUBLIC OF SOUTH AFRICA

DDLR: Office of the Regional Land Claims Commissioner: WC
14 Long Street
Cape Town

TEL: +27-21-
FAX: +27-21-

Consultant

99 Bulwer Street,
Gardens
Capetown 8001
South Africa
t: +27 21 462 1824
f: +27 21 462 1829
e: info@jakupa.co.za

APPROVED: _____ PR. ENG. NO. _____
THE MASTER HELD AT (CONSULTANT COMPANY NAME) BEARS THE ORIGINAL SIGNATURE OF APPROVAL

SIGNATURE: _____ NAME: _____ DATE: _____

Project

**DISTRICT 6
PHASE 3
SITE_Q**

Project Description

RESTITUTION HOUSING

Drawing Title

**APARTMENTS_BLOCK_Q3
ALTERATION-GROUND-FLOOR-PLAN**

| Drawing Units | MILLIMETERS | Drawing Size | A0 |
|------------------------|-----------------------|--------------|----------|
| Date | 2019-05-10 | Scale | AS SHOWN |
| Designed By | DS | Checked By | DS |
| Drawn By | SE | Approved By | GP |
| Consultant Drawing No. | 1304_CN_Q3_PL100A | Rev | 1 |
| Project Drawing No. | D6P3.2_ARC_CN_Q3_100A | Rev | 1 |